

KIT PART NUMBER VE5850
INSTRUCTIONS FOR INSTALLING REGENERATION UCB IN AP 6000/7000
MACHINES.

COMPARE THE PARTS RECEIVED IN THIS KIT WITH THE PARTS LIST IN THE INSTRUCTIONS. IF ANY PARTS ARE MISSING CONTACT THE VENDORS EXCHANGE PARTS DEPARTMENT AT 1-800-321-2311.

Read these instructions carefully before installing the kit.
 Keep these instructions for part numbers and for future reference.

THIS KIT CONTAINS THE FOLLOWING:

INDEX	PART NUMBER	DESCRIPTION	QTY
1	VE5801	UNIVERSAL CONTROL BOARD	1
2	VE5851	HARNESS BOARD RSR715	1
3	VE5852	DISPLAY BOARD RSR723	1
4	VE5853D	DISPLAY HARNESS 11"	1
5	VE5815	POWER SUPPLY	1
6	VE5853	CLEAR DISPLAY LENS	1
7	VE5854	KEYPAD LABEL	1
8	VE5806	STANDOFF (NOT SHOWN)	4
9	VE7363	#4-40 X 1/4" PHILLIPS MS (NOT SHOWN)	4
10	VE7203	#4-40 HEX NUT (NOT SHOWN)	4
11	VE1513	KEYPAD HARNESS	1
12	VE5802E	24VDC POWER HARNESS	1
13	VE5816	MDB HARNESS	1
14	VE5817	DEX HARNESS	1
15	VE5853A	INTERLOCK SWITCH EXTENSION HARNESS	1
16	VE5819	FCC LABEL	1
17		PROGRAMMING INSTRUCTIONS	1

Tools Required:

Phillips Screwdriver or Cordless Screwdriver
Needle nose Pliers
Flashlight

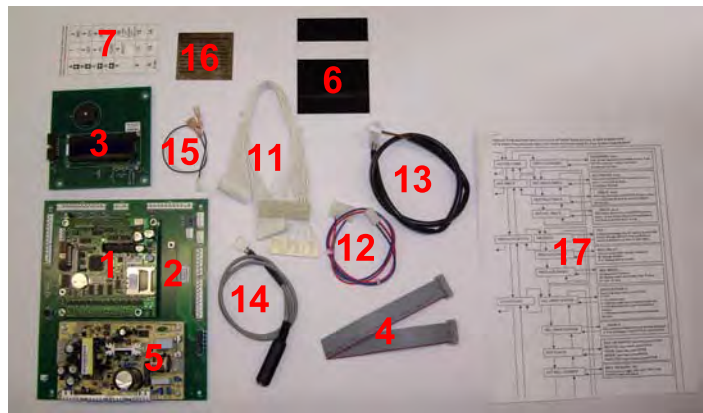

****WARNING****

Electrical Shock Hazard – Turn machine off and disconnect electrical cord from the wall outlet before installing this kit. Failure to do so could result in electrical shock.

1. Read instructions carefully before installing kit.
2. Remove existing coin mech and validator if present. Save Phillips screws.
3. Unplug door switch harness from existing controller PCB.
4. Remove control board cover by removing 4 Phillips screws that secure cover. Discard cover and screws (FIG 1).
5. Unfasten 2 Phillips screws to remove power supply cover. Discard cover and screws (FIG 1).
6. Disconnect all harnesses from controller power supply PCB's.
7. Disconnect door switch harness from door switch and discard. (FIG 2).
8. Remove existing controller and power supply PCBs. Use needle nose pliers to squeeze end of standoffs while pulling corner of PCB away from standoff. Discard both PCBs.
9. Remove existing display PCB by removing 3 Phillips screws. Save screws for reuse (FIG 3).

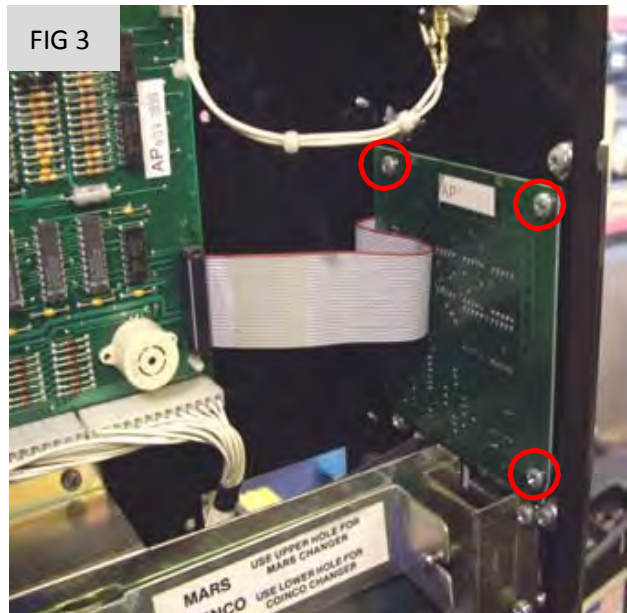
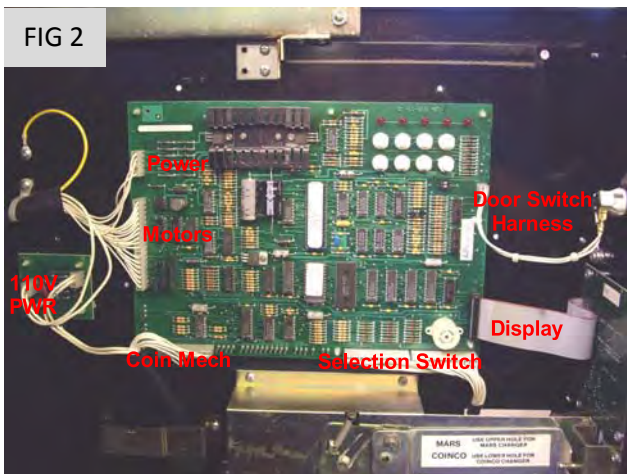
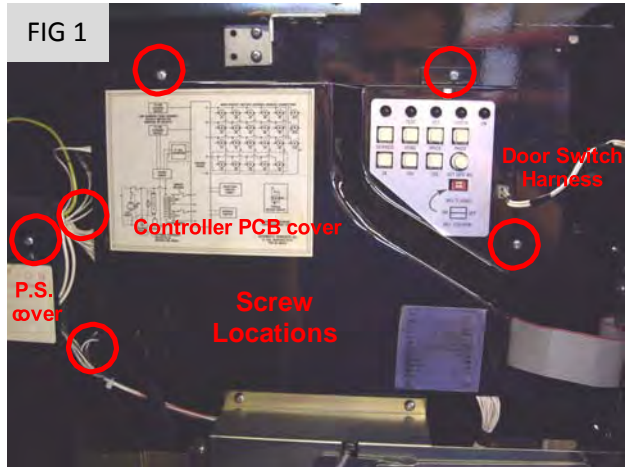

10. Unfasten top 4 Phillips screws and spacer cups of metal frame holding display lens and selection switch assembly in place. Loosen bottom 4 screws. Save screws for reuse (FIGS 4, 5).

11. Gently pull frame forward far enough at top to remove old display lens.

12. Slide in new display lens (kit item).

13. Reinstall 4 Phillips screws and spacer cups from step 10 (FIG 6).

14. Plug display harness (kit item) into display PCB (kit item) (FIG 7).

15. Install display PCB with 3 Phillips screws from step 9 (FIG 7).

16. Connect door switch harness (kit item) (FIG 7).

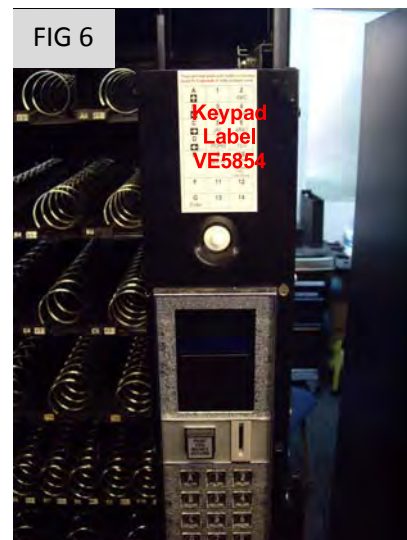
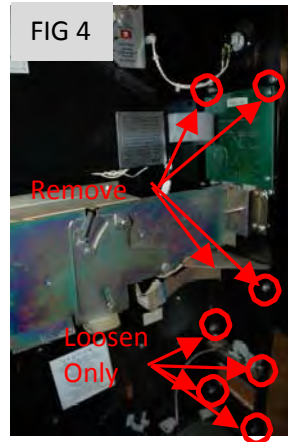

- 1 – FCC label VE5819
- 2 – Not used
- 3 – 110V Power
- 4 M t

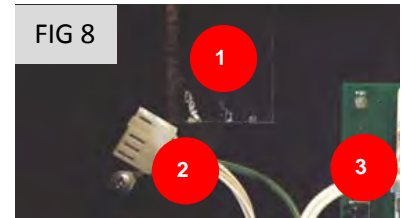

17. Install UCB/Harness board assembly (kit item) onto standoffs from original PCB. Align holes in harness board assembly and press down firmly until standoff snaps into place (FIG 8).

18. Connect ground wire (kit item— attached to power supply PCB) to any solid sheet metal in machine using #8 self-tapping screw (kit item) and 2 – #8 star washers (FIG 10).

19. Connect all harnesses to UCB as shown (FIG 8).

20. Connect selection keypad harness (kit item) to selection keypad. Long harness connects to bottom ribbon. Short harness connects to top ribbon. Pins on harnesses must be forward facing. Align harnesses with keys on ribbons (FIG 9).

21. Install FCC label (kit item) near UCB (FIG 8).

22. Install Programming label (kit item) (FIG 7).

23. Install Keypad label (kit item) as shown. (FIG 6).

24. Install MDB coin mech and validator.

25. Reconnect power cord to outlet. Turn on main power switch.

26. Program machine by following steps outlined in UCB programming instructions provided with kit. Installation is now complete.

