

Installation Instructions for Drop Sensor in AP Machines

1) In order for sensor bracket assembly to fit properly. The stainless steel deflector, running underneath front glass of machine, will need to be lifted and bent. Lift and bend lower corner of deflector, located closest to the hinged side of machine door. **(Figure 1)**

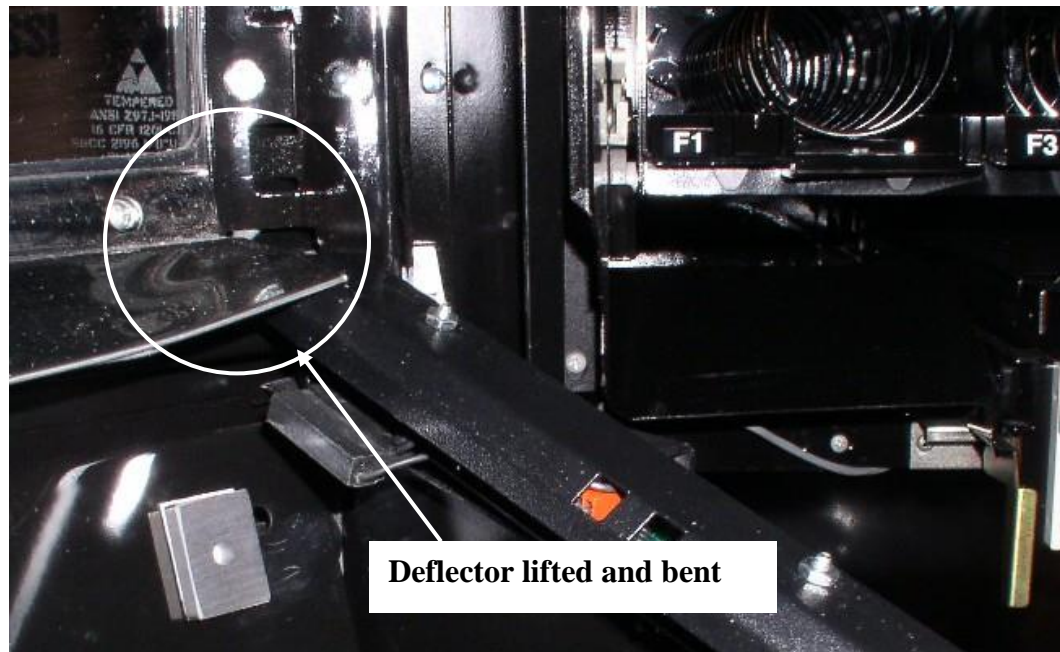

Figure 1 (typical representation)

2) Remove “keps” nut located on outside edge of delivery bucket and replace with plain hex nut supplied in kit (VE 7206). **Note: “Keps” nut needs to be replaced with plain hex nut for electrical grounding reasons.**

3) Install sensor bracket assembly on stud, with plain hex nut, at edge of delivery bucket. Tighten nut and ensure sensor bracket assembly is not tilted or twisted. **Note: After sensor bracket assembly is secured. Check deflector and bracket clearance. Deflector CAN NOT be pressing down on sensor bracket assembly. (Figure 2).**

Installation Instructions for Drop Sensor in AP Machines

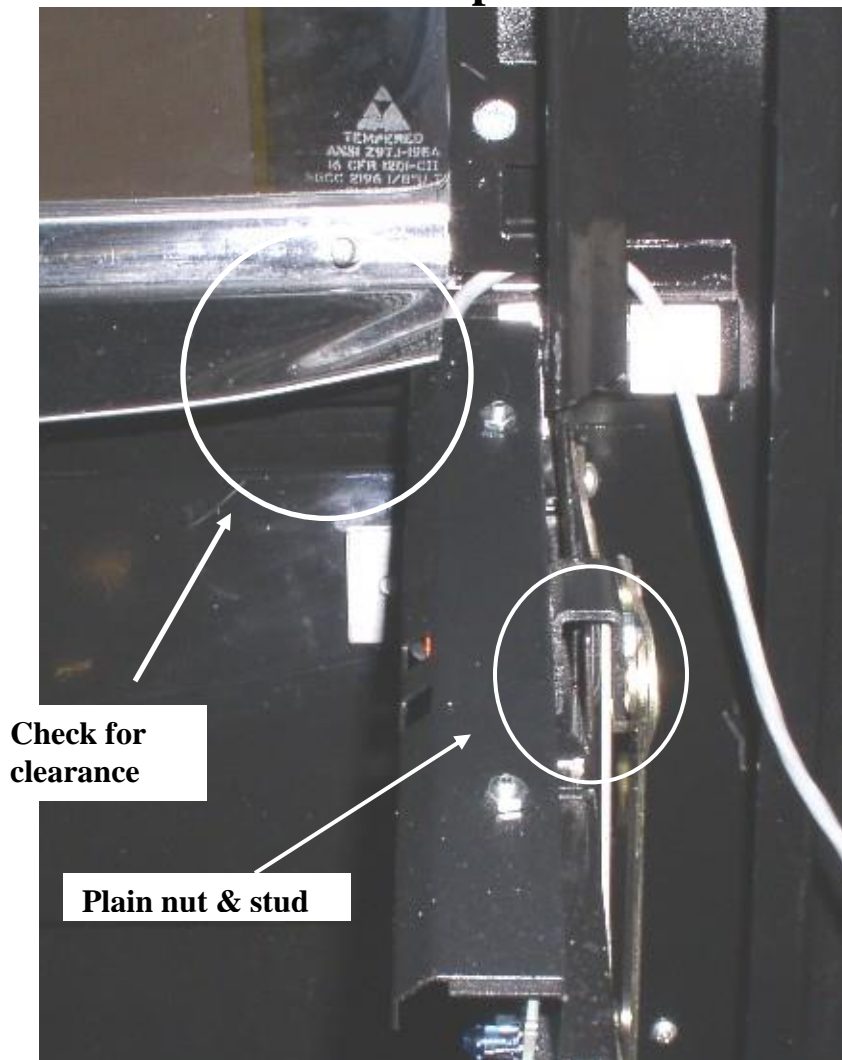

Figure 2 (Typical representation)

4) Plug 4-pin harness into CN8 (AP110 series and AP6000/7000) on SmartBoard harness board. Run 4-pin harness behind power/breaker panel and down to lower plate. Bring harness to the front of plate and continue under the plate. Use cable ties (VE 4601) and cable tie hold-downs (VE 4560), provided in kit, to secure harness under plate. Continue running harness under gum and mint tray toward hinged side main of door.

5) Loosen bottom two front glass-retaining screws and bend bottom of retainer up slightly. Slide 4-pin harness through hole in retainer, under deflector. Retighten to front glass-retaining screws. **Note: Care must be used as not to damage harness. (Figure 3).**

Installation Instructions for Drop Sensor in AP Machines

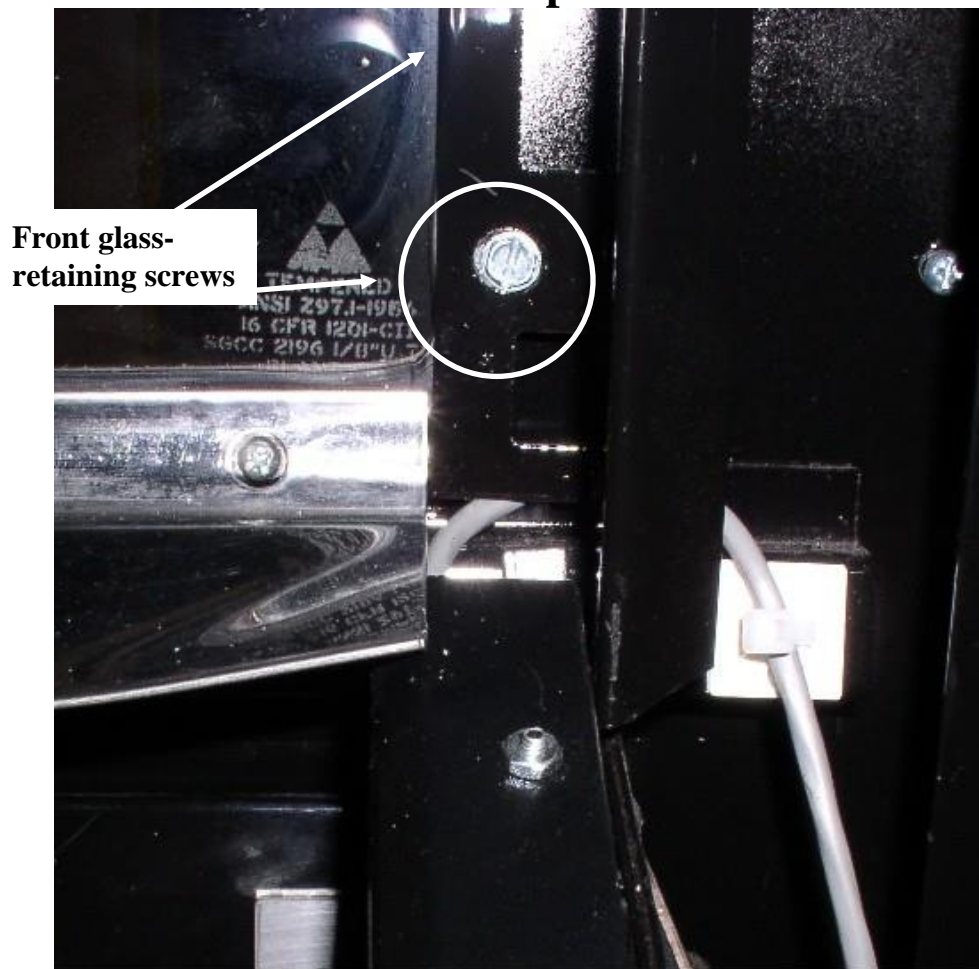

Figure 3 (Typical representation)

6) Top plate of sensor bracket must be removed before 4-pin harness can be plugged into sensor board. Remove two nuts from top of sensor bracket and lift off top plate from sensor bracket. Plug 4-pin harness into sensor board and replace top plate. Reinstall two nuts and tighten. (Figure 4).

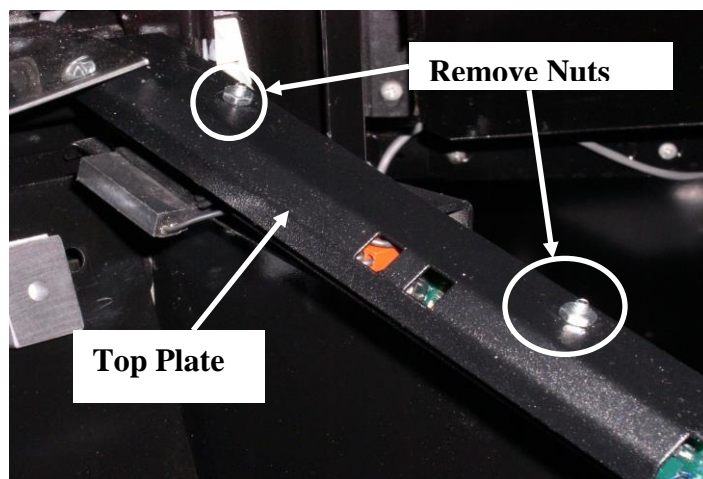

Figure 4 (Typical representation)

Installation Instructions for Drop Sensor in AP Machines

7) Secure 4-pin harness with cable ties (VE 4601) and cable tie hold-downs (VE 4560). **Note: Care must be used when securing harness in area of door hinge as not to damage harness.**

8) Install piece of reflective tape to opposite side of delivery bucket. **Note: When installing reflective tape, position tape as close as possible to rear part of delivery bucket. (Figure 5)**

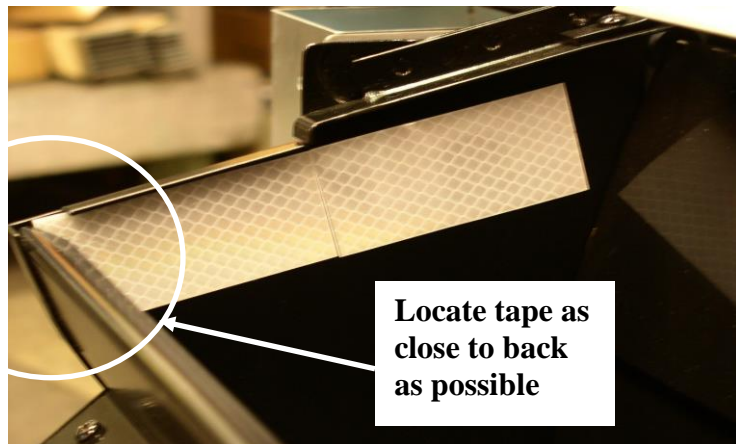

Figure 5 (Typical representation)

9) Install two small pieces of reflective tape to lower edge of roller guide, one on each side of hinge. **(Figure 6)**

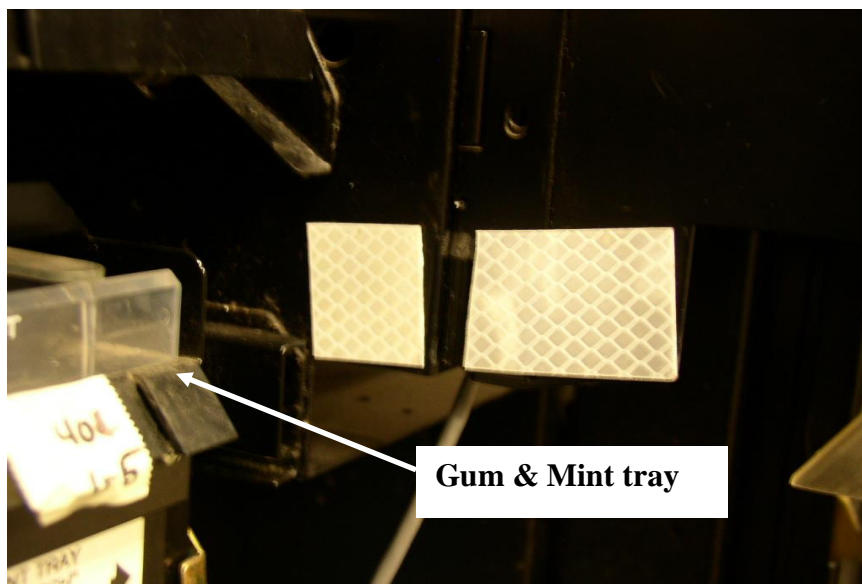

Figure 6 (Typical representation)

10) Reconnect power to machine and turn power switch on.

Installation Instructions for Drop Sensor in AP Machines

11) Locate magnet, included in kit (VE 9308A) with two-sided tape intact, in right hand corner of delivery door approximately 1/8" from top and 1 1/4" from right side. **Note: Do not remove backing on two-sided tape, until ready to permanently affix.**

12) Move delivery door up and down. Green light (LED) on sensor board should go on when door is 1/2 to 2/3 open and go off when delivery door is 3/4 closed. Adjust magnet to get proper results. When proper placement is found remove backing on two-sided tape and affix firmly to delivery door. **(Figure 7).**

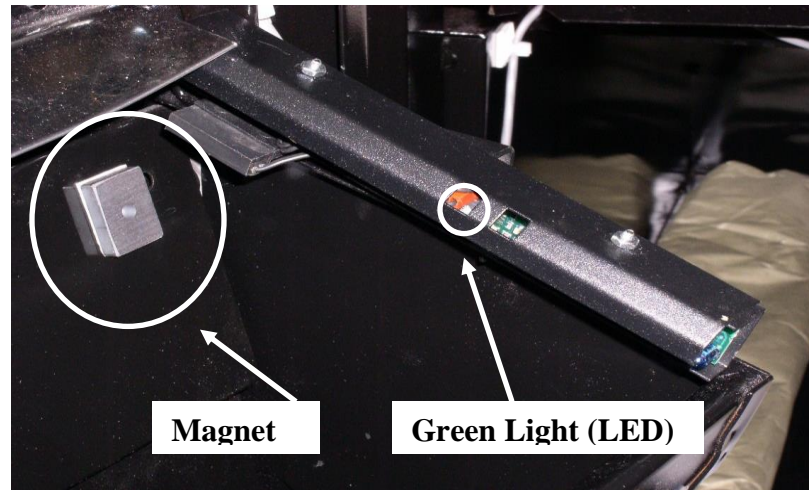

Figure 7 (Typical representation)